

As the demand for product quality increases, metallurgical equipment requires bearings to withstand heavier loads and higher speeds, and thus requires higher performance. Steel companies place more emphasis on equipment normal operation time and performance.

We provide various bearing designs and configurations for steelmaking furnaces, continuous casting machine curved sections, work rolls, back-up rolls, press systems, mill drives, gearboxes, coilers, conveyor rollers and other auxiliary equipment.

The types of bearings include: Tapered roller bearings

Tapered roller bearings use a unique design to withstand axial and radial loads and offer a wide range of assembly options through single and multiple row designs. Our complete range of tapered roller bearing combinations can provide equipment manufacturers and operators with simple, reliable, and high-quality design solutions.

Cylindrical roller bearings - Compared to other types of roller bearings, this design has the highest radial load capacity in the same size. Our extensive line of cylindrical roller bearings - including single row, double row, and multiple row - can help extend equipment life and reduce maintenance costs. Single and double row cylindrical roller bearings are ideal choices for gear drives and other auxiliary equipment applications. The advanced design of four-row cylindrical roller bearings facilitates installation and provides high performance in demanding roll neck applications. Custom designs can also be provided as required for specific applications.



Raw material sintering machine and ring cooler car

Operating conditions: Bearings for raw material sintering machine and ring cooler car are mainly double-row tapered roller bearings, operating under high temperature, low speed, heavy load, and harsh environment. Bearings are generally lubricated with grease through the inner diameter lubrication channel.

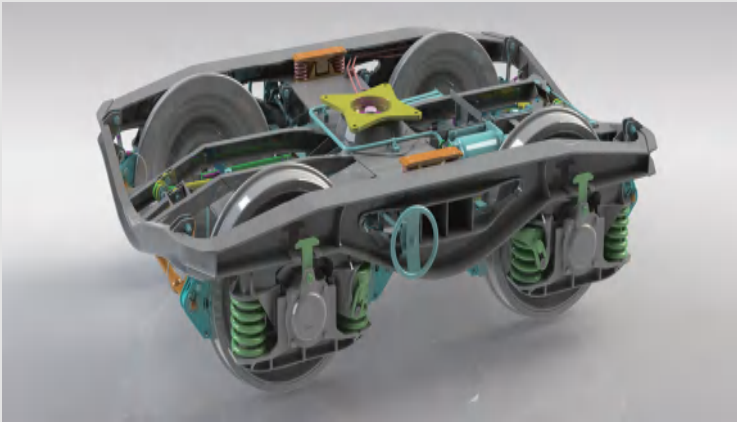

Torpedo tank car steering gear

Operating conditions: Walking bearings for torpedo tank mixer trucks' steering gear require 48 sets of double-row tapered roller bearings for each vehicle, with high load capacity and impact resistance. The bearing life is greatly affected by the condition of the vehicle track, and maintenance is difficult.



Cold Rolled Thin Sheet Rolling Mill

Application: Typical cold rolled thin sheet rolling mills include single stand six-high reversible rolling mills and five stand six-high continuous rolling mills. The bearing configuration of the single stand six-high reversible rolling mill and the five stand six-high continuous rolling mill is as follows: support roll - four-row cylindrical roller bearings in FCDP form or double-row tapered roller bearings; intermediate roll - four-row tapered roller bearings (sealed) or four-row cylindrical roller bearings or double-row tapered roller bearings; work roll - four-row tapered roller bearings (sealed) or four-row cylindrical roller bearings or double-row tapered roller bearings. The inner rings of the four-row cylindrical roller bearings have interchangeability with those used for wire rod mills, but the size of the inner ring raceway is left with a grinding allowance, and the bearing clearance is the clearance after grinding, which can effectively improve the accuracy of the rolling mill and the rolled products. The fully sealed four-row tapered roller bearings are widely used for the work rolls. The rolling line speed is high, and the precision requirements for the bearing of the support roll and the work roll are up to P5. The support roll is generally lubricated with oil and gas, while the work roll and the intermediate roll are generally lubricated with grease.



Board strip

Application: This type of production line is widely distributed, with a rolling width generally below 1m. The rolling mill is divided into rough rolling, medium rolling, and finishing rolling, all of which are hot rolling production. The general configuration includes rough rolling mill, medium rolling mill, finishing rolling mill, and vertical roll mill. The rough rolling mill is generally a two-roll mill, the medium rolling mill is generally a two-roll mill, and the finishing rolling mill is generally a four-roll mill. The four-roll mill: the supporting roller bearings generally use four-row cylindrical roller bearings and double-row thrust tapered roller bearings, and the working roller bearings are configured with four-row cylindrical roller bearings and double-row angular contact (deep groove ball) bearings. Two-roll mill: the roller bearings are generally configured with four-row cylindrical roller bearings, double-row thrust tapered roller bearings, or double-row angular contact bearings.

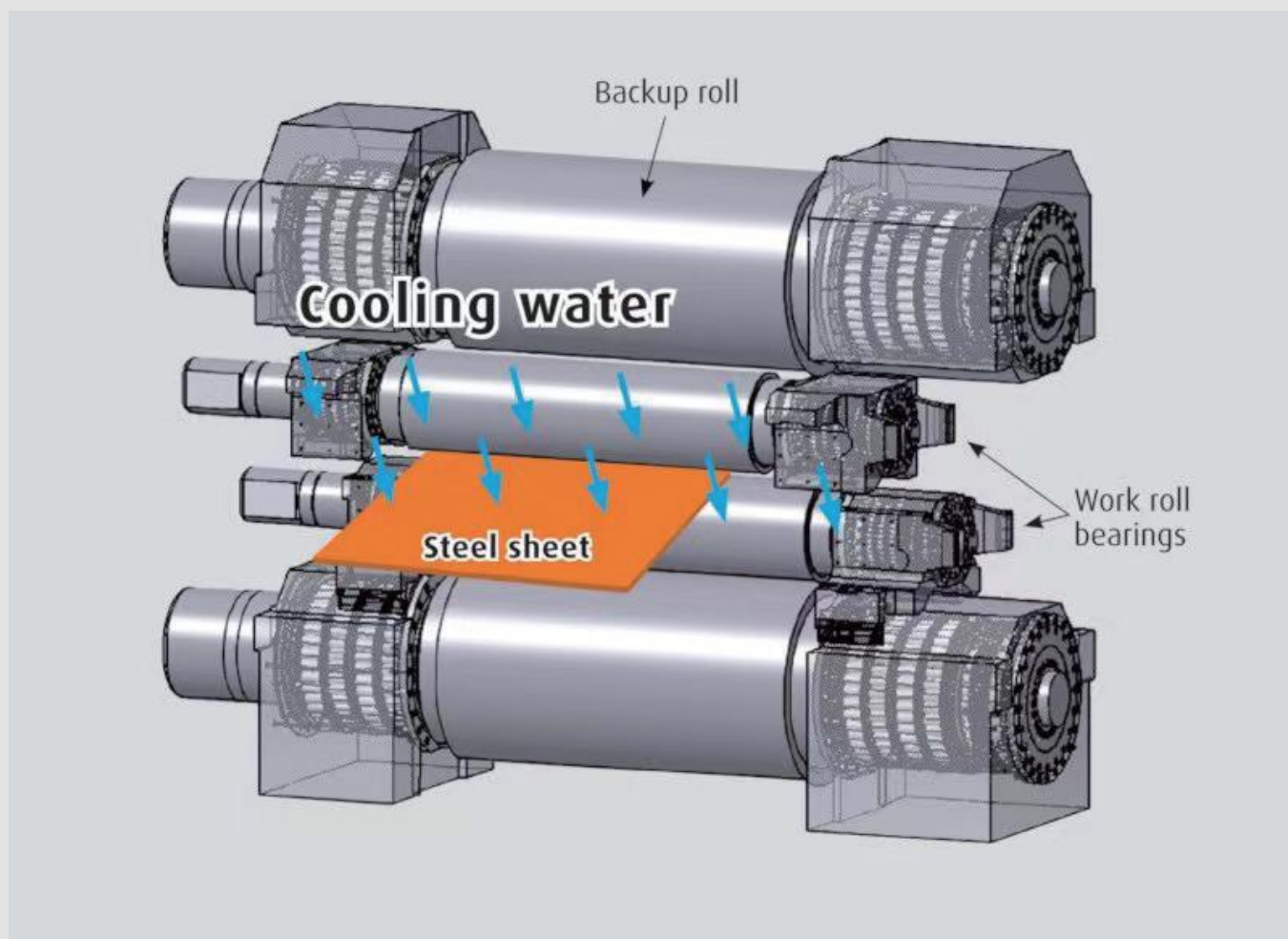

Hot-rolled plate Application:

Hot-rolled plates are divided into thick plates, medium plates, thin plates, strip plates, and other types. In recent years, the development of industry has led to increasingly higher quality requirements for rolled products (plates), mainly reflected in strict plate shape requirements (flatness, thickness, waviness, and other positional tolerances) and significant improvements in mechanical properties such as strength of the plate. This has led to reforms in the rolling process and significant changes in the bearing configuration of the rolling mill rolls. Medium and thin plate production lines are currently the most widely distributed, such as the 2050, 1780, 1500, 1450, and 1250 rolling mill lines, all of which are hot-rolled production lines. They are generally equipped with 1 to 2 roughing mills, 5 to 7 finishing mills, and 2 to 3 edger mills. The roughing mill is generally a two-sided or four-sided rolling mill, and the finishing mill is generally a four-roll rolling mill. A traditional hot-continuous rolling production line usually consists of 1 roughing mill and 7 finishing mills. The rolling mill support roller bearings generally use oil film bearings and double-row tapered roller bearings, while the working roll bearings use four-row tapered roller bearings and double-row tapered roller bearings.



Double row tapered roller bearings for rolling mills

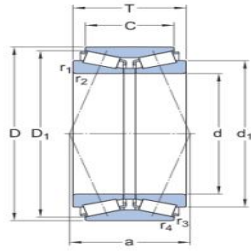

Bearing Numbers	Boundary Dimensions (mm)				Basic Rated Load (kN)		Weight	Ref. number		
	d	D	T	B	Cr	Cor		SKF	TIMKEN	KOYO
351945	228.6	488.95	254	152.4	3 143	4 500	196	331945	HH949549/10D	HH949549/10D
352252	260	480	284	220	4 330	7 350	216	BT2B 328130	//	//
HM256849/10CD/YA1	300.038	422.275	174.625	136.625	2 177	4 750	69.7	BT2B 332504/HA2	HM256849/10CD	HM256849/10D
352968XA/HG2	340	460	160	128	2 196	4 900	70.5	BT2B 332830	//	//
352972X2	360	480	160	128	2 211	5 000	74.7	BT2B 332831	//	//
HM265049/10D	368.249	523.875	214.312	169.862	3 380	7 500	136	BT2B 332603/HA1	HM265049/10D	HM265049/10D
HM266448/10CD	384.175	546.1	222.25	177.8	3 724	8 300	160	331197 A	HM266448/10CD	HM266449/10CD
M268749/10M	415.925	590.55	244.475	193.675	4 175	9 650	205	331656	M268749/10D	M268749/10D
LM869448/10CD	431.8	571.5	155.575	111.125	1 980	5 100	102	BT2B 332604/HA1	LM869448/10CD	LM869448/10D
KM272749/10D	479.425	679.45	276.225	222.25	5 010	12 700	307	331657	M272749/10CD	46T966828
KEE243196/251CD	498.475	634.873	177.8	142.875	2 750	7 350	125	331605 B	EE243196/251CD	EE243196/251D
M274149/10DC	501.65	711.2	292.1	231.775	5500	13700	355	BT2B 332605 A/HA1	M274149/10CD	//
M276449/10CD	536.575	761.873	311.15	247.65	6270	16000	426	BT2B 332446	M276449/10CD	M276449/10CD
LM377449/10CD	558.8	736.6	225.425	177.8	4400	12800	256	331640 A	LM377449/10CD	2TR559D
KEE755280/361CD	711.2	914.4	190.5	139.7	3800	10000	282	BT2B 328028/HA1	EE755280/361CD	EE755280/361D
KEE755285/361D	723.9	914.4	187.325	139.7	3800	10000	255	331554 A	EE755285/361CD	EE755285/361D
LL686947/10D	914.4	1 066.8	139.7	101.6	2600	8000	180	BT2B 332501/HA5	LL686947/10D	//
3519/1160/HC	1 160	1 540	400	290	14200	39800	1896	BT2B 332780/HA5	//	//

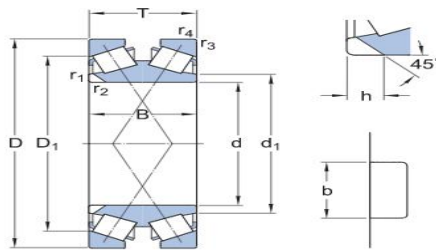

Bearing Numbers	Boundary Dimensions (mm)				Basic Rated Load (kN)		Weight	Ref. number		
	d	D	T	B	Cr	Cor		SKF	TIMKEN	KOYO
370660D	300	440	105	105	1 076	2 040	56	332168	//	45T604411M
3706/305X4HC	305.07	500	200	200	2 700	5200	155	332169 A	//	//
KHM261049D/10	333.375	469.9	166.688	166.688	2600	5900	92.8	BT2B 328695 A/HA1	HM261049D/10	HM261049D/10
HM262749D/10	346.075	488.95	174.625	174.625	2800	6300	97.8	331527 C	HM262749D/10	HM262749D/10
HM266449/10	384.175	546.1	193.675	193.675	3700	8200	152	331158 A	HM266449/10	HM266449/10
370678/HC	390	568	180	180	2610	6520	153	BT2B 334045/HA3	//	//
370680D/HC	400	650	240	240	3 910	8 150	279	332167	//	2TR400L
M268749DW/10S	415.925	590.55	209.55	209.55	4500	9600	195	BT2B 328283/HA1	M268748D/10	45T835921A
M270749ADW/10	447.675	635	223.838	223.838	4400	10900	232	BT2B 332911 C/HA1	M270749D/10	M270748D/10M
M274149DGW/10HC	501.65	711.2	250.825	250.825	5500	13400	326	331182 A	M274149D/10	2TR502
M275349D/10X	519.112	736.6	258.762	258.762	6000	15600	352	BT2B 332662/HB1	M275349D/10	M275349D/M275310
M278749DW/10	571.5	812.8	285.75	285.75	7700	18000	524	BT2B 331854/HA1	M278749D/10	2TR572C
3706/580/HC	580	830	280	280	6 800	16600	546	331677	//	//
3706/635/HC	635	939.8	304.8	304.8	6700	17000	721	331555 B	LM8812545D/LM881214	2TR635D
3706/690/HC	690	980	355	355	10200	25900	880	BT2-8164/HA4	//	//

Four-row tapered roller bearings for rolling mills.

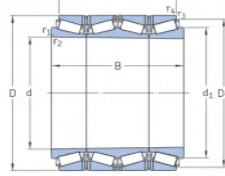
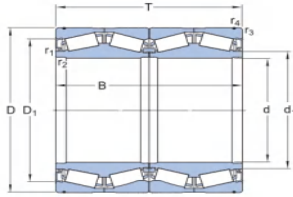

Bearing Numbers	Boundary Dimensions (mm)				Basic Rated Load (KN)		Weight	Ref. number		
	d	D	B	T	Cr	Cor		SKF	TIMKEN	NSK
3806/139.7/HC	139.7	200.025	157.162	160.338	858	2080	16.2	331138 AG	48680D/20/20D	
67791DGW/20/21D	177.8	247.65	192.088	192.088	1230	3000	28.6	331480 G	67791DGW/20/21D	STF177KV2452
67885DGW/20/20D	190.5	266.7	187.325	188.912	1050	3030	32.8	//	67885DW/67820	STF190KV2651
M240648DW/11/11D	198.438	284.162	225.425	225.425	1880	4200	46.6	BT4-0027 AG/HA1	M240648DW/11/11D	
67986D/20/21D	206.375	282.575	190.5	190.5	1400	3350	34.4	BT4-0021 G/HA1	67986D/20/21D	STF206KV2854
380644	220	295	315	315	1993	4050	56.4	BT4-0035 E8/C355	//	
KM244249/10/10D	220.662	314.325	239.712	239.712	2090	4900	60.2	BT4-0040 E8/C355	M244249DGW/10/10CD	
380648/HC	240	338	248	248	2550	5500	72.2	BT4-0020/HA1	JM447749DW/10/10D	STF240KV895
KEE127097D/135/136D	241.478	349.148	228.6	228.6	2160	5000	71.9	330782 AG	EE127097DW/135/136CD	
LM247748DW/10/10D	244.475	327.025	193.675	193.675	1740	4050	42.7	330862 B	LM247748DGW/10/10D	STF244KV3251
M249748/10/10D	254	358.775	269.875	269.875	2720	6050	88.9	BT4-0039 E8/C355	M249748DGW/10/10CD	STF254KV3551
LM451349DW/10/10D	266.7	356.6	230.188	228.6	1950	5800	63.9	BT4-0044 E8/C560	LM451349DGW/10/10CD	STF266KV3552
M252349DW/10/10D	269.875	381	282.575	282.575	2930	7550	105	BT4B 331168 B	M252349DW/10/10CD	
EE13511DW/55/56D	279.4	393.700	269.875	269.875	2880	6200	103	BT4-0011 G/HA1C	EE13511DGW/55/56D	STF279KV3951
M255449DW/10/10D	288.925	406.4	298.45	298.45	3400	8150	125	BT4B 331452	M255449DGW/10/10CD	
M757448DW/10/10D	304.648	438.048	280.99	279.4	3080	6950	131	331492	M757448DGW/10/10CD	STF304KV4353
M258949D/10/10D	304.8	501.65	336.55	336.55	4730	9300	268	BT4B 328909	HM258949D/10/10D	
M257248DW/10/10D	304.902	412.648	266.7	266.7	2930	7000	102	330758 BG	M257248DGW/10/10D	
380662/HC	310	430	310	310	3050	7900	135	BT4-8093 G	//	
LM258648DW/10/10D	317.5	422.275	269.875	269.875	3924	7800	103	BT4-8182	LM258648DGW/10/10D	
HM259047DW/10/10D	317.5	447.675	327.025	327.025	4730	10800	162	BT4B 331161 B	HM259047DGW/10/10D	
M260149DGW/10/11D	330.2	444.5	301.625	301.625	3600	8800	129	BT4B 332647 G	M260149DW/10/10D	
KEE138131D/72/73XD	330.302	438.023	247.65	254	3625	6400	98	BT4-8113	EE138131D/72/73XD	
HM261049DW/10/10D	333.375	469.9	342.9	342.9	4897	11400	188	331381	HM261049DW/10	
LM761649DW/10/10D-3	343.052	457.098	254	254	2800	6900	110	BT4-8160 E8	LM761649DW/10/10D	STF343KV4555
HM262749/10/10D	346.075	488.95	358.775	358.775	5280	12500	224	BT4B 331228	HM262749/10/10CD	
M262449D/10/10D	347.662	469.9	292.1	292.1	2600	7950	142	331092 A	M262449DW/10/10D	
M263349D/10/10DHC	355.6	488.95	317.5	317.5	4750	11000	165	331271	M263349DW/10/10D	
LM763449DW/10/10D	355.6	482.6	265.113	269.875	4150	8150	135	BT4-8162	LM763449DGW/10/10D	
HM265049DW/10/10D	368.3	523.875	382.588	382.588	6200	14800	274	331159 A	HM265049DGW/10/10D	STF368KV5251
HM266449DW/10/10CD	384.175	546.1	400.05	400.05	6120	16400	310	331149 E/C675	HM266448DGW/10/10CD	STF384KV5452
LM665949DW/10/10D	385.762	514.35	317.5	317.5	4150	11000	189	BT4B 334042 E1	LM665949DGW/10/10CD	
LM767749DW/10/10D	406.4	546.1	288.925	288.925	5100	10200	186	BT4-8161 E8	LM767749DGW/10/10D	STF406KV5455
M26749D/10/10D	406.4	565.15	381	381	5900	15200	298	BT4B 331347 AG	M26749DGW/11/11D	
3806/406.4	406.4	546.1	330	330	4900	12500	223	BT4B 334093 BG	//	
M667947DGW/11/11D	409.575	546.1	334.962	334.962	4400	11500	231	BT4B 329004 G	M667947DGW/11/11D	
M268749DGW/10SH/10DSH	415.925	590.55	434.975	434.975	6100	18000	386	//	M268749DGW/10/10CD	STF415KV5951
LM769349DW/10/10D	431.8	571.5	336.55	336.55	6500	14500	233	BT4B 331226 BG/HA1	LM769349DW/10/10D	
M270749DGW/10/10CD	447.675	635	463.55	463.55	8150	21000	485	330608 C	M270749/10/10CD	
M270449DA/410/410D	450	595	404	404	5500	16300	285	BT4-8044 G/HA1VA902	M270449DA/410/410D	
M270749DA/410/410D	450	595	368	368	5250	13400	268	BT4B 332773 E/C725	M270749DA/410/410D	
L770847DGW/10A/10D	457.2	596.9	276.225	279.4	4000	10300	198	331169 E/C500	L770847DGW/10/10D	STF457KV5952
381992X3	460	610	360	360	6100	16400	291	BT4B 331977 E/C725	//	
M272749DGW/10/10D	479.425	679.45	495.3	495.3	9100	23800	582	330886 B	M272749DGW/10/10CD	STF479KV6751
LM272249DW/10/10D	482.6	615.95	330.2	330.2	4860	15200	252	332096 E/C725	LM272249DGW/10/10CD	STF482KV6152
M272449DW/10/10D	482.6	635	421	421	6790	19000	354	//	M272449DW/M272410	
LM772749DGWA/10/10D	489.026	634.873	320.675	320.675	6100	12600	258	331090 E/C700	LM772749DGW/10/10CD	
290698/HC	490	625	385	385	5390	16500	278	BT4-8135 E/C750	NP195018/NP069789	
M274149DW/10/10D	501.65	711.2	520.7	520.7	9690	26900	687	331081 A	M274149DW/10/10D	
3806/509X4HC	509.948	654.924	377	379	5200	17500	312	//	//	STF509KV6551
3806/510/HC	510	655	377	379	5500	16200	316	BT4-8167 E8	NP907899/NP385281	
LM274449DW/10/10D	514.35	673.1	422.275	422.275	7000	21000	408	331157BG	LM274449DGW/10/10D	
LM275349DW/10/10D	520.7	711.2	400.05	400.05	8000	19500	476	BT4B 331243 A/HA1	LM275349D/10/10D	
3806/540/HC	540	690	400	400	6270	11400	375	331978 BG	//	
3806/558XHC	558.8	736.6	322.265	322.268	6270	16600	373	331165 A	EE84322DW/90/91D	
LM377449DGW/10/10D	558.8	736.6	409.575	409.575	6600	20500	460	BT4B 334080 G	LM377449DW/10/10CD	STF558KV7352
3811/560	560	920	620	620	18200	32000	1690	BT4B 328509	NP460735/NP301398/NP028523	
M278749DGW/10/10CD	571.5	812.8	593.725	593.725	13000	36500	1073	BT4B 332666/HA1	M278749DGW/10/10CD	STF571KV8151
LM278849D/10/10D	585.788	771.525	479.425	479.425	10500	30000	615	BT4B 331093 BG/HA1	LM278849DGW/10/10D	
3806/595X4HC	595.312	844.55	615.95	615.95	17300	39000	1125	BT4B 331300 E/C775	M280049DW/10/10D	
M280249DGWA6/10/10D	603.25	857.25	622.3	622.3	14000	38900	1172	331625	M280249DGWA/10/10D	
EE649241D/310/311D	609.6	787.4	361.95	361.95	7100	22000	460	331175 A	EE649242DGW/310/311CD	STF609KV7851
LM280249D/10/10D	609.6	813.562	479.425	479.425	10 600	30500	703	331925	LM280249DGW/10/10D	
3806/625/HC	625	815	480	480	13200	31000	658	BT4-8031 E/C800	NP472983/NP261943	
3819/630/HC	630	850	418	418	6700	22000	683	//	NP143337/JL580914/NP660239	
3806/646X4	646.112	857.25	542.925	542.925	9250	29100	837	//	LM281049DW/10/10D	
3806/650/HC	650	1 030	560	560	17600	39300	1720	BT4B 332827 AG/HA1	//	
L281149DGW/10/10CD	660.4	812.8	365.125	365.125	5300	19800	403	331190	L281149DGW/10/10CD	
M282249D/10/10D	682.625	965.2	701.675	701.675	17400	50000	1714	//	M282249D/10/10CD	
3806/685.8/HC	685.8	876.3	352.425	355.6	5800	14500	490	BT4B 331089 CG/HA1	EE655271DGW/655345	STF685KV8751
2806/710/HC	710	900	410	410	8800	27500	650	331351	//	
3806/711X4/HC	711.2	914.4	390	390	7900	20100	620	BT4-8139 G/HA1	//	
LM282847D/10/10D	717.55	946.15	565.15	565.15	13400	41000	1085	332244	LM282847DW/10/10D	
3806/730HC	730	940	500	500	11624	35200	883	//	NP580440/NP337315	
3806/750/HC	750	950	410	410	10800	27780	703	BT4-8048 E/C725	NP037181/NP327704/NP426265	
3811/750/HCE	750	1220	840	840	30500	71500	3979	//	NP476024/LM184015/NP483799	
M284249DW/10/10D	762	1079.5	787.4	787.4	20500	61900	2340	//	M284249DGW/528800/10CD	
LM286249DGW/10/10D	863.6	1 130.3	669.925	669.925	19800	62000	1885	BT4B 331123 DG/HA1	LM286248DGW/10/10D	
3806/1001/HC	1 001	1 360	800	800	28350	82600		BT4B 334031/HA4C1800	//	

Four Row Cylindrical Roller Bearings

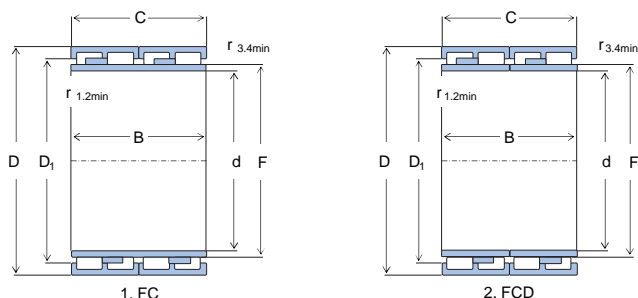

Bearing Numbers	Boundary Dimensions (mm)				Basic Rated Load(KN)		Weight Kg	Ref. number		
	d	D	B	T	Cr	Cor		SKF	TIMKEN	NSK
FC2945156/C3		225	156	156	1100	1800	23.6	BC4-0105	145RYL1452	STF145RV2201g
FC3046156A	150	230	156	156	1120	2090	23.6	BC4-0096		STF150RV2302g
FC3246130A		230	130	130	965	1620	17.3	BC4-0108	160RYL1468	STF160RV2301g
FC32461168A		230	168	168	1290	2200	22	BC4-0103	160RYL1467	STF160RV2302g
FCD3446160	170	230	160	160	1370	2360	23.6	BC4-0118	170RYL6462	//
FC3650156		250	156	156	1220	1950	23.7	//	//	STF180RV2501g
FC3652168		260	168	168	1560	2790	30.2	BC4-0114	180RYL1527	STF180RV2601g
FC3852168A		260	168	168	1450	2600	26	BC4-0098	190RYL1528	STF190RV2601g
FC3854200		270	200	200	1800	3150	35	BC4-0109	190RYL1543	STF190RV2701g
FC4054170		270	170	170	1430	2740	33.3	BC4-0113	200RYL1544	//
FC4054170		280	170	170	1700	3000	33.3	BC4-0095	200RYL1566	STF200RV2804g
FC4056200		280	200	200	1860	3400	39	BC4-0092	200RYL1567	STF200RV2801g
FC4058192		290	192	192	1930	3300	41	BC4-0106	200RYL1585	STF200RV2901g
FC4462192		310	192	192	1900	3600	46.2	BC4-0117	220RYL1621	STF220RV3101g
FC4462225	220	310	225	225	2280	4050	54	BC4-0097	//	STF220RV3102g
FC4666206		330	206	206	2320	43500	57.8	BC4-0112	230RYL1667	STF230RV3301g
FC4668260		340	260	260	2120	5350	82.1	//	//	STF230RV3401g
FC4866220	240	330	220	220	2160	5335	57.1	BC4-0099	240RYL1668	STF240RV3301g
FC5274220		370	220	220	2700	4900	80.4	BC4-0110	260RYL1744	STF260RV3701g
FC5276280		380	280	280	2640	6050	111	//	260RYL1763	STF260RV3801g
FC5678220A		390	220	220	2800	5200	86.5	BC4-0107	280RYL1783	STF280RV3901g
FCD5678275		390	275	275	3750	6950	105	BC4-0100	280RYL1782	STF280RV3903g
FC6084240		420	240	240	3450	6300	111	//	//	STF300RV4201g
FCD6084300		420	300	300	4400	8300	129	BC4-0094	300RX1846	STF300RV4221g
FC6490240		450	240	240	2970	6720	120	//	//	STF320RV4502g
FCD6492240		460	240	240	2700	7050	141	//	D-3716-A	//
FCD6692340	330	460	340	340	3550	9950	210	//	330RX1922	STF330RV4601g
FC6890250	340	450	250	250	2550	7250	112	BC4-8050		STF320RV4501g
FCD72100250/HC	350	500	250	250	4400	8500	151	BC2B 322217/VJ20	360RYL2004	//
FCDP74104380		520	380	380	5230	12000	296	//	370RX2045	//
FCD74108400-KM		540	400	400	4490	13600	327	//		STF370RV5401g
FCD76108400HC	380	540	400	400	5050	14200	297	//	380RX2087	STF380RV5401g
FCD80112410/HC	400	560	410	410	5200	15000	320	//	400RX2123	STF400RV5611
FCDP84120440/HC	420	600	440	440	7210	19500	416	313513	//	STF420RV6011g
FC88132340	440	660	340	340	7210	13700	425	635043	//	//
FCD96130450	480	650	450	450	7840	15400	419	//	480RX2303B	//
FCDP100134450/HC		670	480	450	8 250	22 000		BC4B 322039/HA1	500RX2345A	//
FCDP100144530/HC		720	530	530		17 600		//	500RX2443	STF500RV7211
FCDP102136500/HC	510	680	500	500	9680	26000	522	BC4B 319411	510RX2364	
FCDP104147535/HC	520	735	535	535	11000	27800	757	//	//	STF520RV7331
FCDP106152520/HC		760	520	520	11100	27000	788	//	530RX2522	//
FCDP106156570/HC	530	780	570	570	13000	32000	971	//	//	STF530RV7811
FCDP110148510/HC	550	740	510	510	11000	27800	575	316691	550RX2484	//
FCDP120164575/HC		820	575	575	14000	36000	948	315175 C	600RX2643A	//
FCDP120174640/HC		870	640	640	15700	41000	1337	//	600RX2744	//
FCDP122174660/HC	610	870	660	660	16900	44000	1310	//	//	STF610RV8711
FCDP130184650/HC		900	650	650	16200	42000	1252	//	650RX2803A	//
FCDP130184670/HC	650	920	670	670	14300	44500	1456	//	650RX2841C	//
FCDP130184690/HC		920	690	690	15700	47500	1536	//	//	STF650RV9211
FCDP138196715/HC	690	980	715	715	18800	51500	1805	//	690RX2965	STF690RV9831
FCDP140186620/HC	700	930	620	620	15100	44000	1208	//	700RX2862	STF700RV9311
FCDP142200715/HC	710	1000	715	715	20100	55500	1851		710RX3006	
FCDP150200670/HC	750	1000	670	670	18000	52000	1496		750RX3005	
FCDP152215787X4/HC	761.4	1079.6	787.4	787.4	26600	64000	2376		761RX3166	
FCDP156214780/HC	780	1070	780	780	24200	657000	2170	BC4-8015/HB1	780RX3141	
FCDP160216700/HC	800	1080	700	700	19030	59500	1918		800RX3165	
FCDP164226745/HC	820	1100	745	720	21200	57000	1970	BC4B 316341/HA4	820RX3201A	STF820RV1132g
FCDP170230840/HC		1 150	840	840	27500	75000	2550	315826 B	850RX3304	
FCDP170236850/HC		1 180	850	850	28100	74000	2920	BC4-8021/HB1	850RX3365	STF850RV1111g
FCDP180244840/HC	900	1220	840	840	25300	83500	3050		900RX3444	
FCDP1902721000/HC	950	1360	1000	1000	41500	113000	5027		950RX3723	
FCDP2082881000	1 040	1 440	1 000	1 000	38000	93500	5090	BC4-8062/HA1		